



Evans Stainless Transition Fittings

(PVC, CPVC, SS Tube, Hose barb, Presslok, Pipe Ftgs)



PW Series Fittings

- 1/2" - 3" Sizes
- SS x PVC/CPVC/SS material
- 304 Stainless Steel Union Nut
- Fitting cannot be damaged from over tightening
- Rated to 235 psig / 16 Bar maximum pressure
- (PVC) 140°F / 60°C, (CPVC) 210°F / 98°C max temperature rating
- O-ring material EPDM

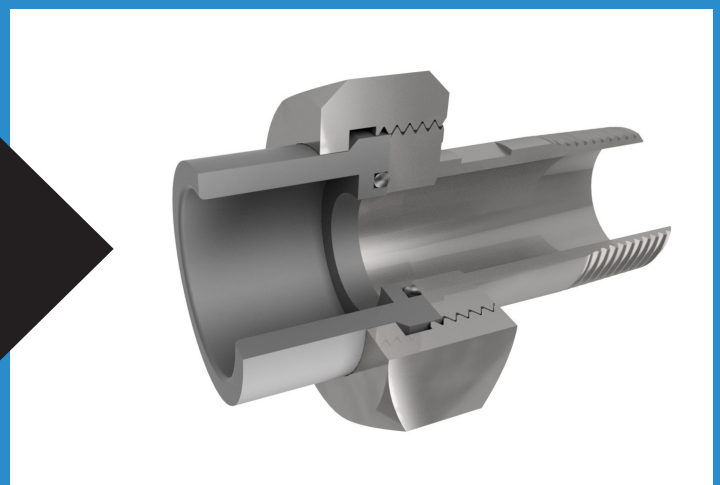

SS x PVC/CPVC Transition Union

304SS MNPT x PVC/CPVC Union

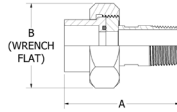

Part Number	Size	Dim A	Dim A	Dim B	Dim B
		IN	mm	IN	mm
PW-08**-SPU-M	1/2"	3.35	85.1	1.80	45.7
PW-12**-SPU-M	3/4"	3.51	89.2	1.875	47.6
PW-16**-SPU-M	1"	3.71	94.2	2.39	60.7
PW-24**-SPU-M	1.5"	4.29	109.0	3.60	91.4
PW-32**-SPU-M	2"	4.77	121.2	4.18	106.2
PW-40**-SPU-M	2.5"	7.17	182.1	5.39	136.9
PW-48**-SPU-M	3"	8.31	211.1	5.39	136.9

304SS FNPT x PVC/CPVC Union

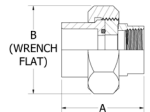

Part Number	Size	Dim A	Dim A	Dim B	Dim B
		IN	mm	IN	mm
PW-08**-SPU-F	1/2"	2.13	54.1	1.80	45.7
PW-12**-SPU-F	3/4"	2.31	58.7	1.875	47.6
PW-16**-SPU-F	1"	2.59	65.8	2.39	60.7
PW-24**-SPU-F	1.5"	3.28	83.3	3.60	91.4
PW-32**-SPU-F	2"	3.53	89.7	4.18	106.2
PW-40**-SPU-F	2.5"	4.42	112.3	5.39	136.9
PW-48**-SPU-F	3"	4.97	126.2	5.39	136.9

304SS Hose Barb* x PVC/CPVC Union

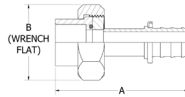

Part Number	Size	Dim A	Dim A	Dim B	Dim B
		IN	mm	IN	mm
PW-08**-SPU-HB	1/2"	3.56	90.4	1.80	45.7
PW-12**-SPU-HB	3/4"	4.17	105.9	1.875	47.6
PW-16**-SPU-06HB	1" X 3/8"	C/F	C/F	2.39	60.7
PW-16**-SPU-08HB	1" X 1/2"	C/F	C/F	2.39	60.7
PW-16**-SPU-12HB	1" X 3/4"	C/F	C/F	2.39	60.7
PW-16**-SPU-HB	1"	4.89	124.2	2.39	60.7
PW-24**-SPU-HB	1.5"	4.64	117.9	3.60	91.4
PW-32**-SPU-HB	2"	4.69	119.1	4.18	106.2

304SS Presslok x PVC/CPVC Union

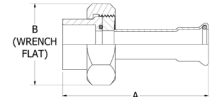

Part Number	Size	Dim A	Dim A	Dim B	Dim B
		IN	mm	IN	mm
PW-08**-SPU-PL [†]	1/2"	C/F	C/F	1.80	45.7
PW-12**-SPU-PL [†]	3/4"	C/F	C/F	1.875	47.6
PW-16**-SPU-PL [†]	1"	C/F	C/F	2.39	60.7
PW-24**-SPU-PL [†]	1.5"	C/F	C/F	3.60	91.4
PW-32**-SPU-PL [†]	2"	C/F	C/F	4.18	106.2
PW-40**-SPU-PL [†]	2.5"	C/F	C/F	5.39	136.9
PW-48**-SPU-PL [†]	3"	C/F	C/F	5.39	136.9

304SS SCH 10 Pipe x PVC/CPVC Union

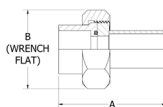

Part Number	Size	Dim A	Dim A	Dim B	Dim B
		IN	mm	IN	mm
PW-08**-SPU-G	1/2"	C/F	C/F	1.80	45.7
PW-12**-SPU-G	3/4"	C/F	C/F	1.875	47.6
PW-16**-SPU-G	1"	C/F	C/F	2.39	60.7
PW-24**-SPU-G	1.5"	4.03	101.6	3.60	91.4
PW-32**-SPU-G	2"	4.00	102.4	4.18	106.2
PW-40**-SPU-G	2.5"	C/F	C/F	5.39	136.9
PW-48**-SPU-G	3"	C/F	C/F	5.39	136.9

304SS Tube x PVC/CPVC Union

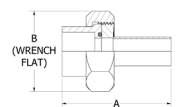

Part Number	Size	Dim A	Dim A	Dim B	Dim B
		IN	mm	IN	mm
PW-08**-SPU-TS	1/2"	3.39	86.1	1.80	45.7
PW-12**-SPU-TS	3/4"	C/F	C/F	1.875	47.6
PW-16**-SPU-TS	1"	3.71	94.2	2.39	60.7
PW-24**-SPU-TS	1.5"	C/F	C/F	3.60	91.4
PW-32**-SPU-TS	2"	4.00	101.6	4.18	106.2
PW-40**-SPU-TS	2.5"	C/F	C/F	5.39	136.9
PW-48**-SPU-TS	3"	7.14	181.4	5.39	136.9

*1/4"-1" hose barb designed for push-lok style hose, no clamp required
 *1.5"-3" hose barb designed for king nipple style hose, clamps required

**PS - PVC Schedule 80 Pipe Socket (Standard)
 **CS - CPVC Schedule 80 Pipe Socket (Optional)

[†] Insert perferred o-ring material
 V - Viton
 E - EPDM

304SS Hose Barb* x Tube Union

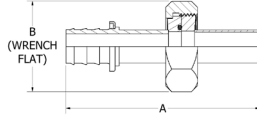

Part Number	Size	Dim A	Dim A	Dim B	Dim B
		IN	mm	IN	mm
PW-08HB-08SU-TS	1/2"	4.89	124.2	1.80	45.7
PW-12HB-12SU-TS	3/4"	5.35	135.9	1.875	47.6
PW-16HB-16SU-TS	1"	5.93	150.6	2.39	60.7
PW-24HB-20SU-TS	1.5"	5.14	130.5	2.97	75.4
PW-32HB-28SU-TS	2"	5.62	142.7	3.60	91.4
PW-48HB-48SU-TS	3"	C/F	C/F	5.39	136.9

304SS Hose Barb* x Presslok Union

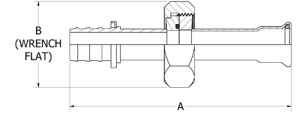

Part Number	Size	Dim A	Dim A	Dim B	Dim B
		IN	mm	IN	mm
PW-08HB-SU-PL†	1/2"	C/F	C/F	1.80	45.7
PW-12HB-SU-PL†	3/4"	C/F	C/F	1.875	47.6
PW-16HB-SU-PL†	1"	C/F	C/F	2.39	60.7
PW-24HB-SU-PL†	1.5"	C/F	C/F	C/F	C/F
PW-32HB-SU-PL†	2"	C/F	C/F	C/F	C/F
PW-48HB-SU-PL†	3"	C/F	C/F	5.39	136.9

304SS SCH 10 Pipe x Tube Union

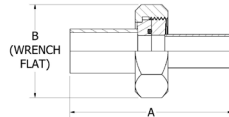

Part Number	Size	Dim A	Dim A	Dim B	Dim B
		IN	mm	IN	mm
PW-08G-SU-TS	1/2"	C/F	C/F	1.80	45.7
PW-12G-SU-TS	3/4"	C/F	C/F	1.875	47.6
PW-16G-SU-TS	1"	C/F	C/F	2.39	60.7
PW-24G-SU-TS	1.5"	C/F	C/F	C/F	C/F
PW-32G-SU-TS	2"	C/F	C/F	C/F	C/F
PW-40G-SU-TS	2.5"	C/F	C/F	5.39	136.9
PW-48G-SU-TS	3"	C/F	C/F	5.39	136.9

304SS Presslok x Tube Union

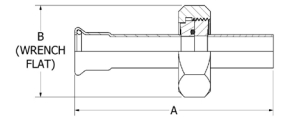

Part Number	Size	Dim A	Dim A	Dim B	Dim B
		IN	mm	IN	mm
PW-08PL†-SU-TS	1/2"	C/F	C/F	1.80	45.7
PW-12PL†-SU-TS	3/4"	C/F	C/F	1.875	47.6
PW-16PL†-SU-TS	1"	C/F	C/F	2.39	60.7
PW-24PL†-SU-TS	1.5"	C/F	C/F	C/F	C/F
PW-32PL†-SU-TS	2"	C/F	C/F	C/F	C/F
PW-40PL†-SU-TS	2.5"	C/F	C/F	5.39	136.9
PW-48PL†-SU-TS	3"	C/F	C/F	5.39	136.9

304SS Tube x Tube Union

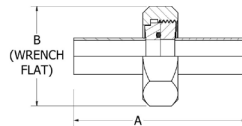

Part Number	Size	Dim A	Dim A	Dim B	Dim B
		IN	mm	IN	mm
PW-08TS-SU-TS	1/2"	C/F	C/F	1.80	45.7
PW-12TS-SU-TS	3/4"	C/F	C/F	1.875	47.6
PW-16TS-SU-TS	1"	C/F	C/F	2.39	60.7
PW-24TS-SU-TS	1.5"	C/F	C/F	C/F	C/F
PW-32TS-SU-TS	2"	C/F	C/F	C/F	C/F
PW-40TS-SU-TS	2.5"	C/F	C/F	5.39	136.9
PW-48TS-SU-TS	3"	C/F	C/F	5.39	136.9

Dimensions are +/-0.2"

*1/4"-1" hose barb designed for push-lok style hose, no clamp required
 *1.5"-3" hose barb designed for king nipple style hose, clamps required (king nipple style hose barbs available for 1/4"-1" upon request)

† Insert preferred o-ring material
 V - Viton
 E - EPDM

NOTE: Product availability and specifications contained herein are subject to change without notice. Consult local distributor or factory for potential revisions.

Learn more about related Evans Products



Evans PW Series
1/2" thru 4" PCWS/R Hook Up Sticks



Evans Custom Water Stick
Supply and Return Manifolds



EVANS PW-HB Series
PROCESS COOLING WATER Tee's, Elbows, Manifolds & Flanges w/ Hose Barb Connections



Features

- 1/4" - 2" Sizes
- 304L/316L SS welded construction
- All components pressure rated to 150 psig /10 Bar max @ 185°F/85°C max.
- He leak tested to 1 x 10⁻⁷ scq/sec
- All assemblies bagged and labeled in clean-room



Evans SG-30 Series
3 pc 304L Mini Ball Valves

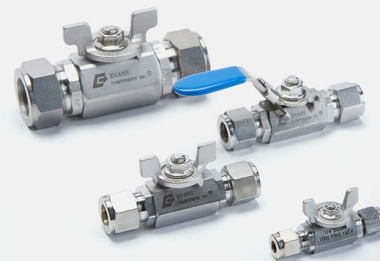

Features

- CF8M Cleaned
- Helium leak rated to 1 X 10⁻⁷ scq/sec
- Economical one piece hex body design
- Compact, comes standard with butterfly handle
- Locking lever handle, optional
- Easy to operate, low torque



www.evanscomponents.com

7606 SW Bridgeport Road
Portland, Oregon 97224

Office 971.249.1600

Fax 971.249.1601